

SURE-STOP PVC WATERSTOP INSTALLATION GUIDELINES

INTERNAL & EXTERNAL STYLE SURE-STOP PVC WATERSTOPS

1. Prior to placement, all Sure-Stop PVC Waterstop joins and intersections must be welded together on site using our recommended welding and joining procedure (refer to our "CJS Sure-Stop PVC Waterstop Site Joining Guidelines" brochure). In some instances the waterstops may have to be welded together after initial installation or after concrete placement has taken place because continuation of the Sure-Stop PVC Waterstop could not be performed prior, due to placement difficulties etc.
2. Sure-Stop PVC Waterstop should be positioned inside the joint so that one half of the waterstop width is embedded into each concrete pour. (Refer FIG. 1)
3. INTERNAL Sure-Stop PVC Waterstops must be securely tied into position through the pre-punched eyelets located on the external outer flanges of the waterstop. These are positioned every 150mm apart along both outer edges of the waterstop, giving a very secure fixing position. In vertical joint applications, the placement of formwork is then positioned below and on top of the waterstop by butting up to it from both sides, achieving a split formwork outcome, which also helps secure/hold the waterstop into position. (Refer FIG. 2) Usually in horizontal joint applications no formwork is required.
4. EXTERNAL Sure-Stop PVC Waterstops are to be secured into position by concrete nails that are hammered through the specially designed outer flange areas of the waterstop, into the lean concrete base (blinding layer) for slab on ground applications or by nails or screws into the formwork, for wall applications. In vertical joint applications the placement of formwork is then positioned on top of the waterstop by butting up to it. This also helps secure/hold the waterstop into position. (Refer FIG. 3)
5. To achieve an ultimate installation procedure, carefully place the concrete so as not to displace Sure-Stop PVC Waterstop from its position. Thoroughly vibrate concrete around the waterstop to avoid air entrapment and to provide a positive contact between the waterstop and the concrete. Particular care should be taken when installing internal waterstops for slab on ground applications to make sure concrete is fully vibrated and compacted around and underneath the waterstop and all its ribs. (Refer FIG. 4)
6. Please also refer to our "CJS Sure-Stop PVC Waterstop Site Joining Guidelines" for further information on Sure-Stop PVC Waterstop welding/joining procedures and preparation and installation procedures.

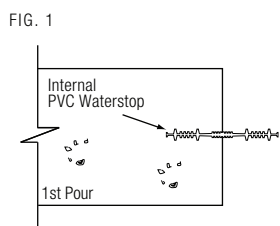

SLAB ON GROUND OR WALL APPLICATION

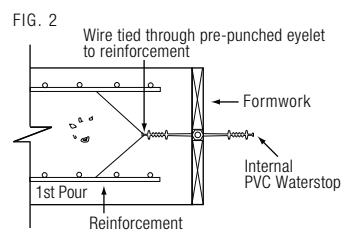

SLAB ON GROUND OR WALL APPLICATION

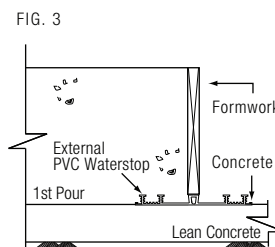

SLAB ON GROUND APPLICATION

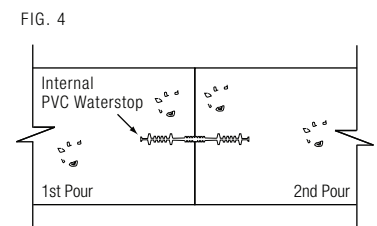

SLAB ON GROUND OR WALL APPLICATION

The information and the recommendations relating to the application and end use of this product are given in good faith and are based on the information provided by the manufacturer of the product and / or the Company's current knowledge and experience in connection with the product when properly stored, handled and applied under normal conditions and no liability of final function at the job site is assumed. In practice, the differences in materials, substrates and actual site conditions are such that no warranty in respect of merchantability of or fitness for a particular purpose, nor any liability arising out of any legal relationship whatsoever, can be inferred either from this information, or from any written and / or oral recommendations, or from any other advice offered by the Company. No responsibility or liability by the Company will be accepted for misuse, misreading or derivation from the recommended guidelines in respect of this product and the user shall determine the suitability of the product for his intended use and assume all risks and liability in connection therewith. The information contained in this brochure may change at any time without notice.

Effective Date: 10 May 2012